

Model 835 Bonded Strain Gage Oceanographic/ Submersible Pressure Transmitter

SPECIFICATIONS

Pressure Media	Fluids or gases compatible with Inconel 718. Other materials available.	Proof Pressure	Application of 3 times full scale pressure will not cause any change in performance characteristics.
Case Material	316L Stainless Steel	Burst Pressure	Greater than 4.5 times full scale pressure.
Excitation	20-36 Vdc. Reverse polarity protected.	External Case Pressure	15,000 psi maximum
Full Scale Output	5.000 ± 0.050 Vdc for a 50K ohm load or greater	Pressure Fitting	1/2" NPT female. Options available.
Zero Balance	0.000 ± 0.050 Vdc at 70° F	Electrical Connector	Brantner XSJ-5BCR. Mating electrical connector with 2 feet of neoprene cable supplied with unit.
Insulation Resistance	Greater than 1000 megohms at 50 Vdc between both leads in parallel and case at 70° F	Weight	Approximately 45 ounces
Accuracy	±0.25% of span including linearity, hysteresis, and repeatability		
Operating Temperature Range	-30° F to 170° F		
Compensated Temperature Range	30° F to 100° F		
Thermal Zero Error	Less than ±0.010% FSO per °F over compensated temperature range		
Thermal Sensitivity Error	Less than ±0.010% FSO per °F over compensated temperature range		

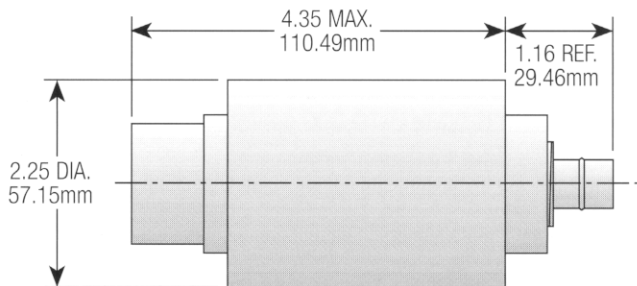

HOW TO ORDER

All 12 spaces
must be used.

Spaces 1-3 Specify model number.
Spaces 4 and 5 Choose pressure range. If non-standard range,
pick the closest range above the special.
*Notes: 1) Option "OF" must be used.
2) See conversion factors below.*

Space 6 Specify pressure format (PSIS Standard).
Spaces 7-12 Specify options in the order that they
appear alphabetically.
*Notes on Options: 1) Place the code AA in unused option spaces.
2) Consult factory for more than 3 options.*

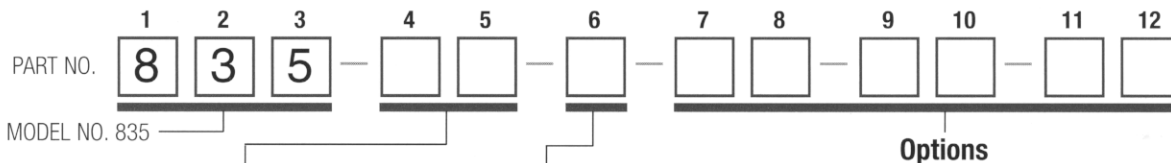

PRESSURE RANGES (PSI)

BJ: 0-50 BS: 0-750
BK: 0-75 BT: 0-1000
BL: 0-100 BV: 0-2000
BM: 0-150 BX: 0-3000
BN: 0-200 BZ: 0-5000
BP: 0-300 CC: 0-7500
BR: 0-500 CD: 0-10,000

PRESSURE FORMAT

2: PSIS
3: PSIA
5: PSID (Consult
Factory)

NO OPTIONS

AA: None

ELECTRICAL CONNECTORS

Consult Factory

PERFORMANCE OPTIONS

OA: Improved Accuracy
OB: Improved Temp
OD: Internal Cal. Shunt
OF: Special Pressure Range (Please
specify range & unit of measure)
OG: Special 20 Point Calibration
OI: Special Temp Range

PRESSURE PORTS

PC: 1/4" NPT F
PD: 1/4" NPT M
PF: 1/2" NPT M

CONVERSION FACTORS

Multiply Feet of Water by 0.4335 to get PSI
Multiply Meters of Water by 1.422 to get PSI