

# Model 935

# Bonded Strain Gage Oceanographic/ Submersible Pressure Transmitter

## SPECIFICATIONS

<b>Pressure Media</b> . . . . .	Fluids or gases compatible with Inconel 718. Other materials available.
<b>Case Material</b> . . . . .	316L Stainless Steel
<b>Excitation</b> . . . . .	12-40 Vdc. Reverse polarity protected.
<b>Full Scale Output</b> . . . . .	4-20 mA
<b>Span</b> . . . . .	16.00 ± 0.16 mA
<b>Zero Balance</b> . . . . .	4.00 ± 0.16 mA
<b>Insulation Resistance</b> . . . . .	Greater than 1000 megohms at 50 Vdc between both leads in parallel and case at 70° F
<b>Accuracy</b> . . . . .	±0.25% of span including linearity, hysteresis, and repeatability
<b>Operating Temperature Range</b> . . . . .	-30° F to 170° F
<b>Compensated Temperature Range</b> . . . . .	30° F to 100° F
<b>Thermal Zero Error</b> . . . . .	Less than ±0.010% FSO per °F over compensated temperature range
<b>Thermal Sensitivity Error</b> . . . . .	Less than ±0.010% FSO per °F over compensated temperature range

<b>Proof Pressure</b> . . . . .	Application of 3 times full scale pressure will not cause any change in performance characteristics.
<b>Burst Pressure</b> . . . . .	Greater than 4.5 times full scale pressure
<b>External Case Pressure</b> . . . . .	15,000 psi maximum
<b>Pressure Fitting</b> . . . . .	1/2" NPT female. Options available.
<b>Electrical Connector</b> . . . . .	Brantner VSG-2BCL. Mating electrical connector with 2 feet of neoprene cable and G-FLS-X locking sleeve supplied with unit.
<b>Weight</b> . . . . .	Approximately 35 ounces

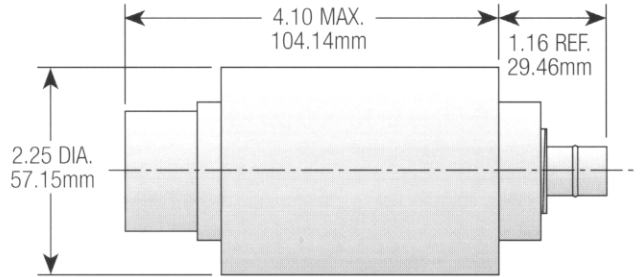

## HOW TO ORDER

All 12 spaces  
must be used.

**Spaces 1-3** Specify model number.  
**Spaces 4 and 5** Choose pressure range. If non-standard range,  
pick the closest range above the special.  
*Notes: 1) Option "OF" must be used.  
2) See conversion factors below.*

**Space 6** Specify pressure format (PSIS Standard).

**Spaces 7-12** Specify options in the order that they  
appear alphabetically.

*Notes on Options: 1) Place the code AA in unused option spaces.  
2) Consult factory for more than 3 options.*

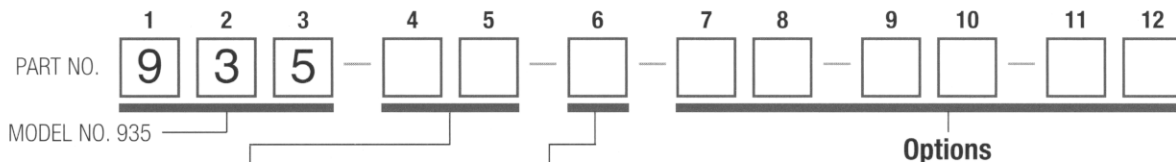

### PRESSURE RANGES (PSI)

BJ: 0-50	BS: 0-750
BK: 0-75	BT: 0-1000
BL: 0-100	BV: 0-2000
BM: 0-150	BX: 0-3000
BN: 0-200	BZ: 0-5000
BP: 0-300	CC: 0-7500
BR: 0-500	CD: 0-10,000

### PRESSURE FORMAT

2: PSIS
3: PSIA
5: PSID (Consult Factory)

### NO OPTIONS

AA: None

### ELECTRICAL CONNECTORS

Consult Factory

### PERFORMANCE OPTIONS

OA: Improved Accuracy
OB: Improved Temp
OD: Internal Cal. Shunt
OF: Special Pressure Range (Please specify range & unit of measure)
OG: Special 20 Point Calibration
OI: Special Temp Range

### PRESSURE PORTS

PC: 1/4" NPT F
PD: 1/4" NPT M
PF: 1/2" NPT M

### CONVERSION FACTORS

Multiply Feet of Water by 0.4335 to get PSI  
Multiply Meters of Water by 1.422 to get PSI